

Touch Switches

Touch-Sensitive Switch with LED Illumination

BR30 Series

DIMENSIONS (Unit: MM)

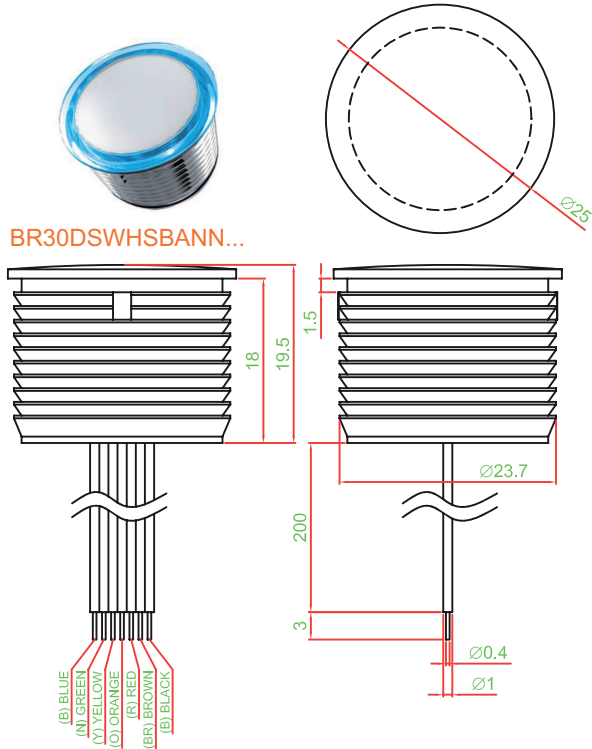

SWITCH SPECIFICATIONS

Poles and Positions: One channel
 Protection: Moisture and dust-tight
 Circuit: Capacitive analog signal
 Operating Temperature: -20°C to +70°C

Electrical Characteristics						
Symbol	Parameter	Conditions	Min.	Typ.	Max.	Units
V _{CC}	Operating Voltage		2.0	3.0	5.5	V
F	System Oscillator	V _{CC} = 3V		16		KHz
F _{SEN}	Sensor Oscillator	V _{CC} = 3V, Output no load		1M		Hz
V _{IH}	Input Ports	V _{CC} = 3V, Output no load		1.5	3.0	μA
V _{IL}	Input Ports	Input low Voltage	0		0.2	V
I _{OP}	Operating Current	Input high Voltage	0.8		1.0	V
I _{OL}	Output Port Sink Current	V _{CC} = 3V, VOL=0.6V		8		mA
I _{OH}	Output Port Source Current	V _{CC} = 3V, VOH=2.4V		-4		mA
T _R	Output Response Time	V _{CC} = 3V			220	ms
R _{PH}	Input Pin Pull-High Resistor	V _{CC} = 3V		35K		Ω
R _{PL}	Input Pin Pull-Low Resistor	V _{CC} = 3V		28K		Ω

LED SPECIFICATIONS

	Unit	Value / LED Color		
		Green	Yellow	Red
Forward Current	I _f mA	20	20	20
Reverse Voltage	V _r V	5.0	5.0	5.0
Reverse Current	I _r μA	10	10	10
Forward Voltage @ 20mA	V _f V	2.1 to 2.5	2.0 to 2.5	2.0 to 2.5
Luminous Intensity @ 20mA	I _v mcd	60	120	150

PANEL CUTOUT

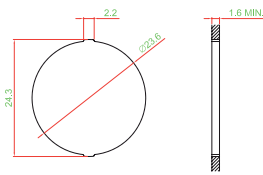

SCHEMATIC

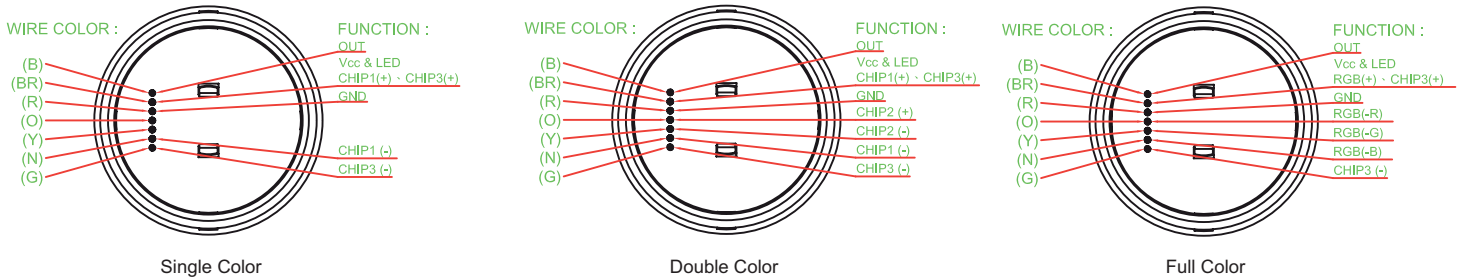

How to order:

BR30

- 1 OPERATING TYPE**
D Direct Mode (Standard)
T Toggle Mode
- 2 POLE:**
S Single Pole (Standard)
- 3 TERMINATION:**
W Wire Type
- 4 ACTIVITY:**
H High Active (Standard)
L Low Active
- 5 FRAME:**
S Standard Type
- 6 HOUSING COLOR:**
B White Light (Standard)
- 7 DIFFUSER PLATE COLOR:**
A Black(Standard)
- 8 CAP SYMBOL:**
N Without Symbol
... Please refer to appendix in the last page for example:
K3
E1
- 9 CAP SYMBOL TYPE:**
N Without Symbol
P Printed Symbol
L Laser Carved Symbol
- 10 COLOR LED 1 (Chip 1 Inside):**
N Without LED
G Blue
F Green
C Red
B White
E Yellow
D Orange
V Full Color
- 11 COLOR LED 2 (Chip 2 Inside):**
N Without LED
G Blue
F Green
C Red
B White
E Yellow
D Orange
- 12 COLOR LED OUTER RING (Chip 3):**
N Without LED
G Blue
F Green
C Red
B White
E Yellow
D Orange
- 13 SENSITIVITY:**
18 18 pF (Standard)
16 16 pF
20 20 pF
- 14 CABLE & CONNECTOR:**
N Without Cable
S Cable Length 200 mm (Standard)
... Other Length...

All specifications are restricted to QA test criteria.
 DRW: D.L. JIN, CHK: D.F. LEE, APP: H.Z. QIU

SPECIFICATIONS

1. POLE - POSITION : One-Chanel
2. CIRCUIT FEATURE : Capacitive analog signal
3. FEATURES OF LED TOUCH SWITCH :
 - 3.1 Operating voltage recommended 3.5~5.5 V(DC)
 - 3.2 Built-in regulator for touch sensor (2.0V)
 - 3.3 The response time max about 220mS @VCC=3V.
 - 3.4 Sampling length time about 1.6mS.
 - 3.5 Provides direct mode or toggle mode by pad option.
 - 3.6 Output modes can be selected active high or active low by pad option.
 - 3.7 the surface can display in two different designs: 1. symbol display in the middle by RGB LED 2. outer circle background controlled by single chip of LED; the LED is independent installed and both can be reacted by external chips.
 - 3.8 Auto calibration for life, the re-calibration period is about 4.0sec, when key has not be touched.
4. DESCRIPTION OF LED TOUCH SWITCH :

SINGLE COLOR

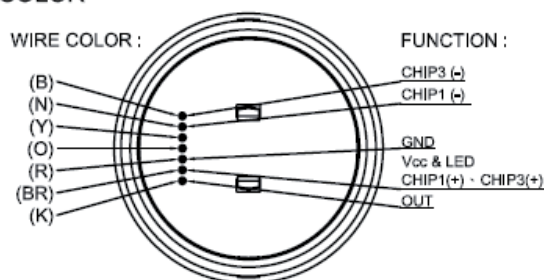

TWO COLOR

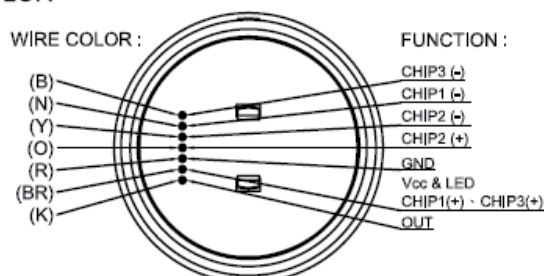

FULL COLOR

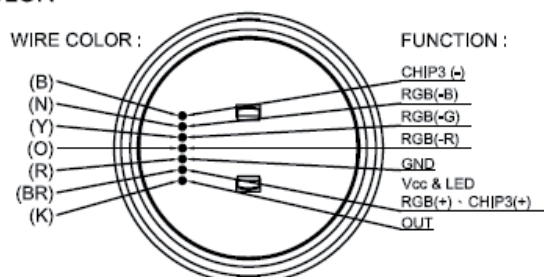

5. PIN DESCRIPTION OF LED TOUCH SWITCH :

Pin No.	Wire Color	Pin Function Description		
Con1	B(Black)	Vcc 、 chip1+(chip1.1+) 、 chip2+		
Con2	BR(Brown)	VCC		
Con3	R(Red)	GND		
		Full Color	Single Color	Two Color
Con4	O(Orange)	chip1 R-	-	chip1.2+
Con5	Y(Yellow)	chip1 G-	-	chip1.2-
Con6	N(Green)	chip1 B-	chip1-	chip1.1-
Con7	B(Blue)	chip2-		

6. BLOCK SCHEMATIC OF LED TOUCH SWITCH :

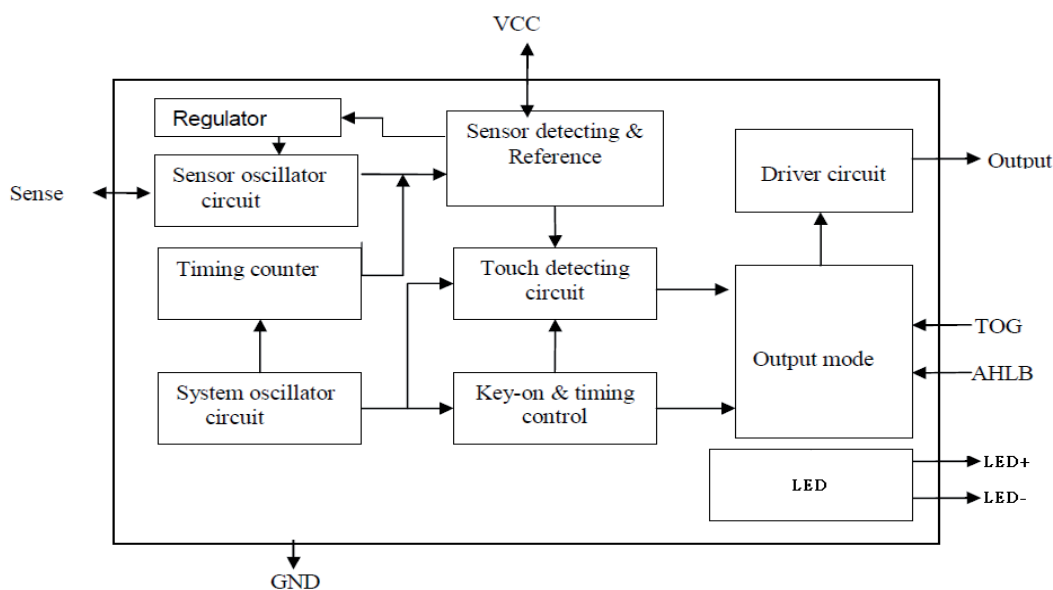

7. TYPICAL APPLICATION OF LED TOUCH SWITCH :

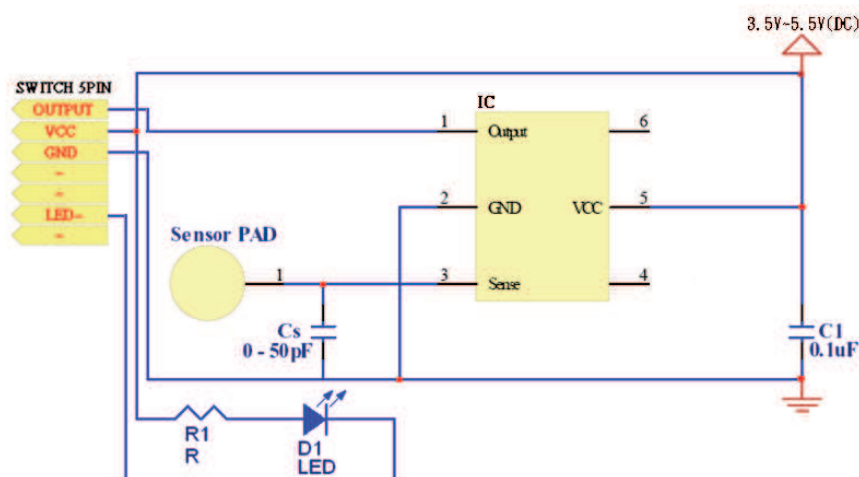

8. ABSOLUTE MAXIMUM RATINGS OF LED TOUCH SWITCH :

Parameter	Symbol	Conditions	Value	Unit
Operating Temperature	TOP	-	-20 ~ +70	?
Storage Temperature	TSTG	-	-50 ~ +125	?
Power Supply Voltage	VCC	Ta=25?	GND-0.3 ~ GND+5.5	V
Input Voltage(TOG / AHLB)	VIN	Ta=25?	GND-0.3 ~ VCC+0.3	V
ESD	ESD	-	? 4	KV

Note : GND is system ground

9. ELECTRICAL CHARACTERISTICS :

Symbol	Parameter	Conditions	Min	Typ.	Max	Units
VCC	Operating Voltage		3	3.5	5.5	V
F	System oscillator	VCC=3V		16		KHz
FSEN	Sensor oscillator	VCC=3V ,Output no load		1M		Hz
VIH	Input Ports	VCC=3V ,Output no load		1.5	3.0	uA
VIL	Input Ports	Input Low Voltage	0		0.2	V
IOP	Operating Current	Input High Voltage	0.8		1.0	V
IOL	Output Port Sink Current	VCC=3V, VOL=0.6V		8		mA
IOH	Output Port Source Current	VCC=3V, VOH=2.4V		-4		mA
TR	Output Response Time	VCC=3V			220	mS
RPH	Input Pin Pull-high Resistor	VCC=3V		35K		Ω
RPL	Input Pin Pull-low Resistor	VCC=3V		28K		Ω

10. SENSITIVITY MODE :

1	Standard	Conductive distance.								
2	Capacitance	How to order : (16pF : H ; 20pF : L)								
<table border="1"> <thead> <tr> <th colspan="2">SENSITIVITY</th> </tr> </thead> <tbody> <tr> <td><input type="checkbox"/></td> <td>18 pF (std.)</td> </tr> <tr> <td>-16P</td> <td>16 pF</td> </tr> <tr> <td>-20P</td> <td>20 pF</td> </tr> </tbody> </table>			SENSITIVITY		<input type="checkbox"/>	18 pF (std.)	-16P	16 pF	-20P	20 pF
SENSITIVITY										
<input type="checkbox"/>	18 pF (std.)									
-16P	16 pF									
-20P	20 pF									

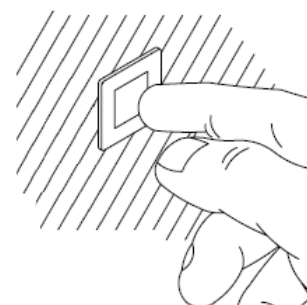

11. APPLICATION NOTE :

- 11.1 After power-on have about 0.5sec stable-time, during this time do not touch the key pad. And the function is disabled. If the supply voltage drift or shift quickly, maybe causing false detections.
- 11.2 The material of panel covering on the Switch can not include the metal or the electric element.
- 11.3 At Direct mode: IC Maximum on time about 80 Sec.

12. MATERIALS :

Cover: PC

Actuator: POM

Base Frame: PA + GF

Terminals: Phosphor bronze silver plated

Spring: Phosphor bronze silver plated

Touch Switches

Touch-Sensitive Switch with LED Illumination

BR30 Series

13. SYMBOLS :

	0	1	2	3	4	5	6	7	8	9	10	11	12	13	14	15	16	17	18	19
A	0	1	2	3	4	5	6	7	8	9										
B	A	B	C	D	E	F	G	H	I	J										
C	K	L	M	N	O	P	Q	R	S	T										
D	U	V	W	X	Y	Z	POWER	ON OFF	ON	OFF										
E	OK		Auto	Enter	Start	STOP	OPEN	CLOSE	Exit	Move										
F	SET	Reset	Light	Alarm	Menu	Next	Back	Delete	Motor	Save										
G	Up	Down	Right	Left	Test	End	Insert	Lock	Print	+/-										
H	ESC	BC.	HOME	Health	D-LED 2	OC GENIE	VIDEO INPUT	clr CMOS	Green Power	Save OK										
I	B/R +	Uncl Cancel	T/L -	F1	F2	F3	F4	F5	F6	F7										
J	F8	F9	F10	F11	F12	F13	F14	IN 1	IN 2	IN 3										
K	IN 4	IN 5	IN 6																	
L	+	-	x	÷	=	↑	→	≡	▶	⏪										
M							↑	→	↑	⇒										
N	↑	→	↗	↖	▲	▶	◀	▶	◀	▶										
O	■	⏸	⏪	⏩	⏪	⏩	🔊	🔊	📶	📶										
P				✗	✓	⏹	Config.	TIME LINE	ME1	ME2										
Q	ME3	ME4	BGND 3D DVE1	BGND 3D DVE2	BUS COLOR	ME BUTTON LINK	*	INSERT ←	WIPE											
R	⏪	ALL		VP		COPY		RECORD MODE	↕											
S		♥	mute																	
T		hold	group	m1	m2	m3	m4	m5	e1	e2										
U	e1	e2	chair	undo	redo	touch	store	recall	e1	e2										
V	e3	e4				CLEAR	CROSS WIND	AMMO TEMP	BARO PRESS	AIR TEMP										
W	BORE- SIGHT	CANT	LEAD	RANGE	MRS	ZERO	TEST	UD	LR											
X	ID	Disp																		