

Slide Switches

Mini Slide Switches / Attenuator

Part Number: **SB_254H06**

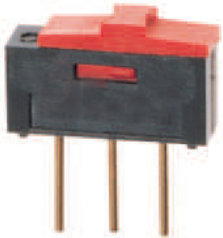

SBS254H06

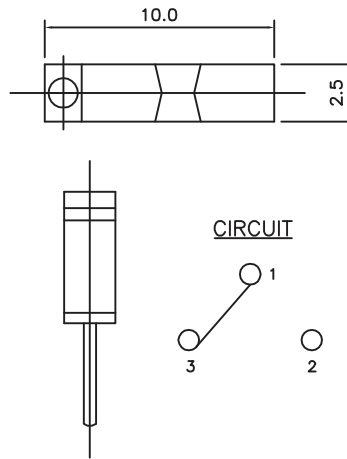
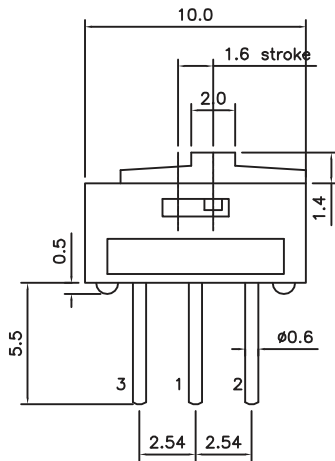

P.C.B DIMENSION

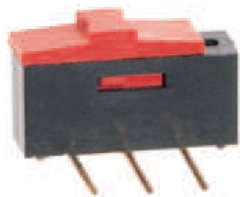
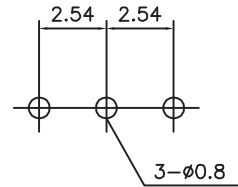

SBR254H06

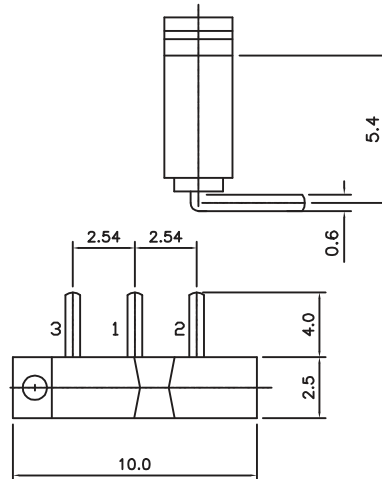
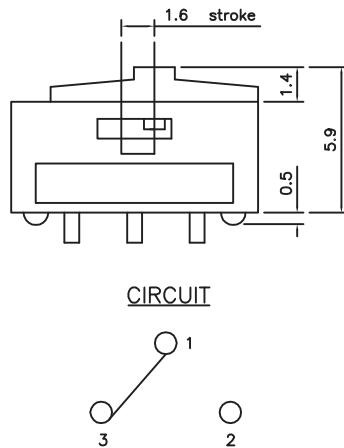

P.C.B DIMENSION

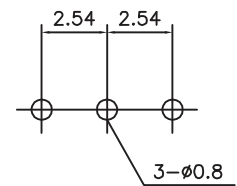

General Specifications:

1. Electrical Characteristics.

- > Rating: AC, DC 12V 0.5A / 24V 0.3A (Min. 1mA)
- > Contact Resistance: 30 mOhms Max
- > Insulation Resistance: 10,000 mOhms Min. at 500VDC
- > Withstanding Voltage: 500VAC at 1 Minute

2. Mechanical Characteristics.

- > Operating Force: 800gf Max.
- > Angle of Lever Throw
- > Insulator: Case: Glass Fiber Reinforce Polyamide (UL94 V-0)
Slide: Glass Fiber Reinforce Polyamide (UL94 V-0)
- > Terminal: Nickel(Ni 0.2μ) Gold Plate(Au 0.05μ)

3. Life Test.

- > Test Condition: Operations at a rate of 15-20 Cycle 1 minute
with load: 1,000 Cycles
without load: 1,000 Cycles
- > Operating Force: with +10%, -40% of Initial Value
- > Contact Resistance: 30 mOhm Max

4. Environmental Characteristics.

- > Operating Temperature: -40°C to +85°C
- > Storage Temperature: -40°C to +85°C
- > Humidity Test:
 - > Test Conditions:
 - Measured 1 Hour after Exposure to Ambient
 - After 96 Hour Exposure at 40±2°C, 90-95%R.H
 - > Insulation Resistance: 10,000 mOhms Min. at 500VDC
 - > Withstanding Voltage: 500VAC at 1 Minute
- > Saline Spray Test: 24 Hours

5. Solder Conditions.

- > at 270°C within 5 Sec.

6. RoHS Compliant

All specifications are restricted to QA test criteria.
DRW: D. L. JIN, CHK: D.F. LEE, APP: H.Z. QIU, DC: 2013-04-23, UPD: 2015-10-29