

3 Position

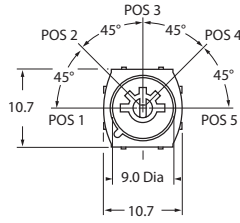

5 Position

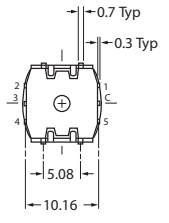
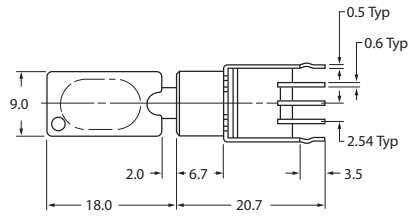

SK13AEG13

Straight PC with Bracket

On 3-position models terminals 1 & 5 are support pins.

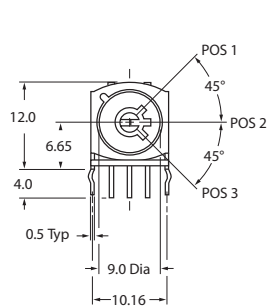
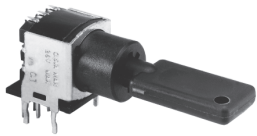

3 Position

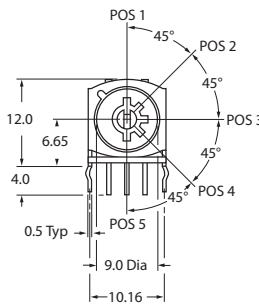

5 Position

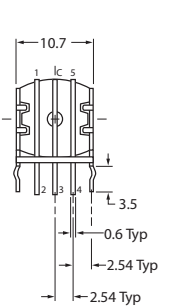
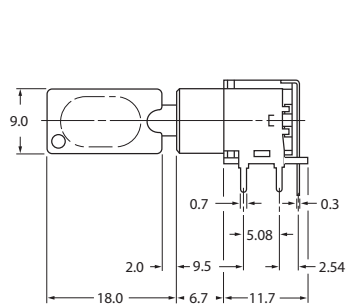

SK15AEG30

Right Angle PC

On 3-position models terminals 1 & 5 are support pins.

POLES, CIRCUITS & KEY-REMOVABLE POSITIONS

CUTAWAY

Pole & Throw	Model	Key Positions					Connected Terminals					Schematic	⊙ = Key Removable ● = Not Removable ∨ = Maximum Arc
		Pos 1	Pos 2	Pos 3	Pos 4	Pos 5	Pos 1	Pos 2	Pos 3	Pos 4	Pos 5		
SP3T	SK13A	ON	ON	ON	---	---	COM-1	COM-2	COM-3	---	---		
SP5T	SK15A	ON	ON	ON	ON	ON	COM-1	COM-2	COM-3	COM-4	COM-5		

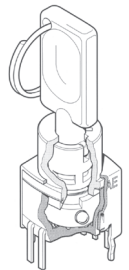

KEY

STRAIGHT PC TERMINALS WITH BRACKET

RI

RHT ANGLE PC

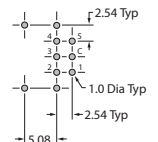
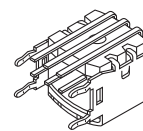
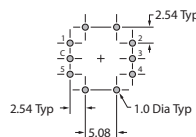
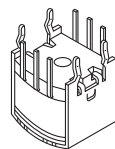
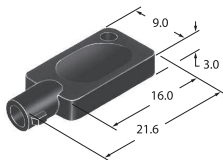

How to order:

SK

1 POLES:
1 SP3T / SP5T

2 POSITIONS:
3 ON-ON.ON.NONE-NONE
5 ON-ON-ON-ON-ON

3 KEY REMOVABLE:
A All Positions

4 BUSHING:
E 9mm Diameter Smooth

5 CONTACT MATERIAL:
G Gold, Rated 0.4VA @ 28V AC/DC

6 TERMINALS:
13 Straight with Bracket
30 Right Angle

General Specifications:

- ELECTRICAL CAPACITY (Resistive Load)
 - » Logic Level: 0.4VA @ 28 V AC/DC max.
- OTHER RATINGS:
 - » Contact Resistance: 100m Ω max.
 - » Insulation Resistance: 100M Ω min.@500VDC
 - » Mechanical Life: 30,000 cycles min.
 - » Electrical Life: 20,000 cycles min.
 - » Nominal Operating Torque: 0.0002Nm
 - » Contact Timing: Break-before-make
 - » Angle of Throw: 45° for 3-position & 5-position
- MATERIALS
 - » Terminals: Phosphor bronze with tin plating
 - » Movable Contact: Beryllium copper with gold plating
 - » Stationary Contacts: Phosphor bronze with tin plating
- ENVIRONMENTAL DATA
 - » Operating Temperature: -25°C through +70°C
- SOLDERING
 - » Wave Soldering recommended. Manual Soldering 4 sec. max. @ 390°C max.