

# Pushbutton Switches

Micro Travel Anti-Vandal Pushbutton Switch - Mounting Hole Ø16mm **PAV16M** Series



Terminal Type: 24AWG Wire Leading  
Illumination: Ring Illuminated Red

PAV16MFW2C\_N

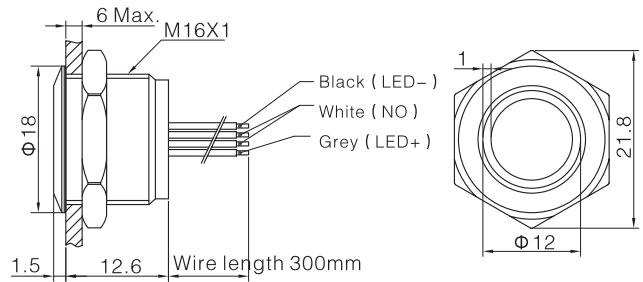

Terminal Type: Solder Lug 2.8x0.5mm  
Illumination: Ring Illuminated Blue

PAV16MFS2G\_N

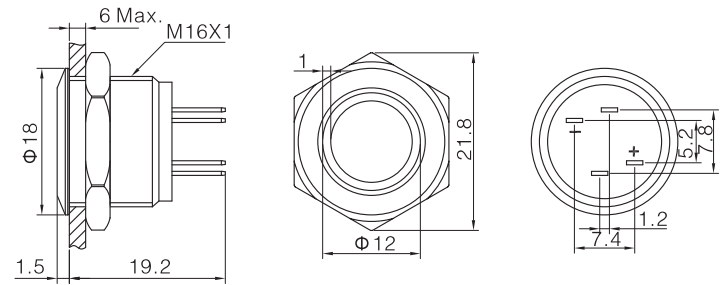

## LED SPECIFICATIONS

Lamp Type	LED Lamp AC/DC *			Lamp Circuit Diagram
Rated Voltage	AC/DC6V	AC/DC12V	AC/DC110V	
	AC/DC24V	AC/DC36V	AC/DC220V	
Rated Amper	about 15mA		about 3mA	
LED Colors	red, green, yellow, orange, blue, white			
Life	40,000 hours (reference)			

a — R — LED — b

Using AC/DC LED lamp, the terminals have not difference of anode and cathode; Using inner resistance, don't need to connect outer resistance.

\* DC LED and other voltages can be made by request.

## How to order:

PAV16M

### 1 OPERATING TYPE:

M Momentary

### 2 FRONT SHAPE:

F Flat Round

### 3 TERMINATION:

W Wire Leading 300mm (standard)  
S Solder Lug (made by request)

### 4 ILLUMINATION:

2 Ring Type Illumination

### 5 LED COLOR:

C Red  
F Green  
E Yellow  
G Blue  
B White

### 6 LED VOLTAGE:

6 AC/DC 6V  
12 AC/DC 12V  
24 AC/DC 24V  
(Other Voltage can be made by request)

### 7 ENGRAVING:

A Stop B Start C Return D Reset  
E | F || G ◀ H ↑  
J ■ K ⏻ L ⚡ M ⚙  
N ○  
(Other engraving can be made by request)

## General Specifications:

### CHARACTERISTICS

- > Protection Degree: IP65
- > Anti Vandal Degree: IK05
- > Switch Rating: 50mA 24VDC
- > Operation Type: Momentary
- > Contact Configuration: 1NO
- > Contact Resistance: 100mΩ Max.
- > Insulation Resistance: 1000MΩ Min.
- > Operating Temperature: -20°C to +55°C
- > Mechanical Life: 500,000 cycles
- > Electrical Life: 500,000 cycles
- > Panel Thickness: 1 to 6mm
- > Torque: about 0.6Nm
- > Operation Pressure: about 3.8N
- > Operation Travel: 0.5mm
- > Switching: Single-Break Contact

### MATERIALS

- > Contact: Silver alloy
- > Button: Stainless steel
- > Body: Stainless steel
- > Base: PBT