

Rotary Switches

10 x 10 mm Sealed Rotary DIP Switches

RD82 Series

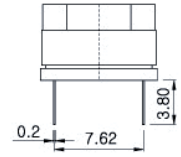
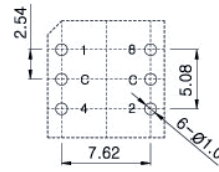
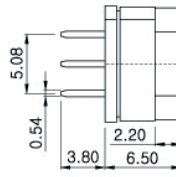
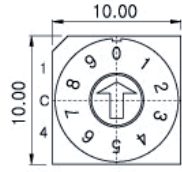

RD82(T)HR

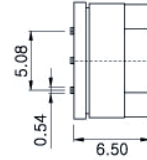
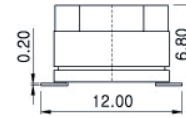
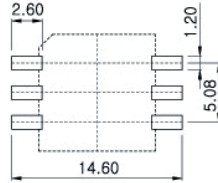
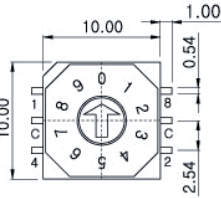

RD82(T)SO

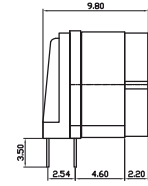
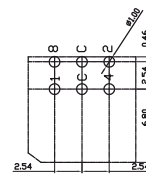
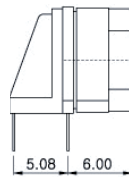
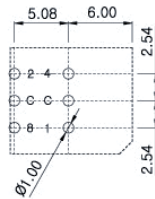
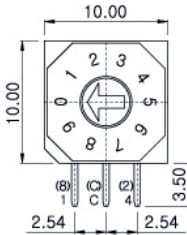
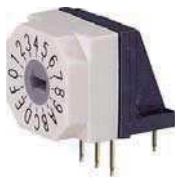

RD82(T)A20

ROTOR TYPE

ACCESSORIES

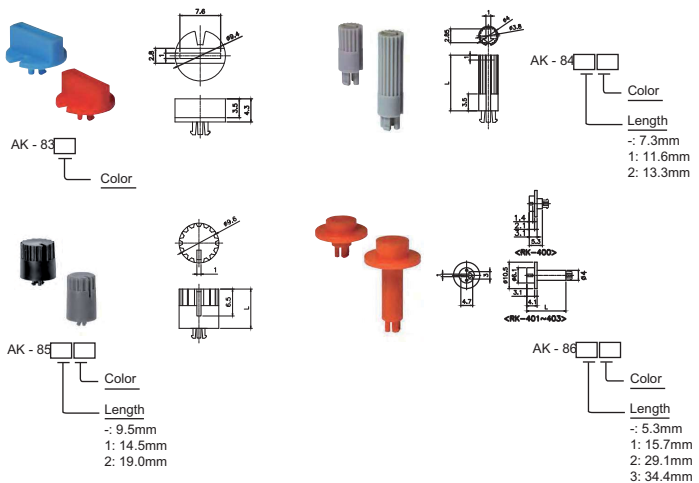
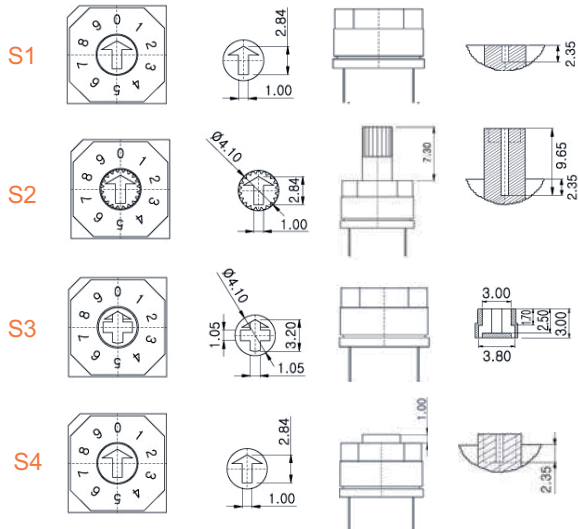

Color Options: H: Grey C: Red A: Black E: Yellow G: Blue
Applicable to only "S3" actuator, Should be mounted after soldering

How to order:

RD82

- | | | |
|---|---|-----------------------------|
| 1 SOLDERING CONDITIONS: | 3 TYPE OF CASE: | 6 CODE (See Page 2): |
| blank Iron & Wave Soldering | O Octagon Type | R Real Code |
| T Reflow Soldering 10s/260°C by SMT & THR Terminals | R Round Type | S Complementary Code |
| 2 TYPE OF TERMINALS: | 4 ROTOR TYPE (See Above Drawings): | G Gray Code |
| H THT Top Adjust Type 3:3 | S1 Arrow Type | NR Special Code 1 |
| HC THT Top Adjust Type 3:2 | S2 Shaft Type | NS Special Code 2 |
| A1 THT Right Angle Side Adjust Type with Rows Spacing 2.54 mm | S3 Cross Type | ND Special Code 3 |
| A2 THT Right Angle Side Adjust Type with Rows Spacing 5.08 mm | S4 Raised Type | NE Special Code 4 |
| S SMT Top Type 3:3 | 5 NO. OF POSITIONS: | NF Special Code 5 |
| SC SMT Top Type 3:2 | 04 4 Positions | NG Special Code 6 |
| | 06 6 Positions | NH Special Code 7 |
| | 08 8 Positions | 7 PACKAGING TYPE: |
| | 10 10 Positions | TB Tube |
| | 16 16 Positions | TR Tape & Reel (SMT Only) |

General Specifications:

- FEATURES**
- » Sealing: IP 67(Dust & Waterproof). Except Cross Type of Actuator S3
- MECHANICAL**
- » Life Cycle: 10,000 steps
 - » Operating Force: 700 gf max.
 - » Operating /Storage Temp. for THT Type: -40°C to +85°C
 - » Operating / Storage Temp. for THR Type: -60°C to +125°C
- ELECTRICAL**
- » Contact Rating: 150mA, 24V (Switching) 400mA, 24V (None-Switching)
 - » Contact Resistance: 80mΩ Max
 - » Insulation Resistance: 100MΩ Min
- SOLDERING CONDITIONS**
- » THT Type: Solder iron max: 2s./340°C Solder bath max: 5s/280°C
 - » THR Type: Reflow Soldering: 10s./260°C Solder iron max: 2s/340°C Wave Soldering: 5s/280°C
 - » SMT Type: Reflow Soldering: 10s./260°C Solder iron max: 2s./340°C Solder bath max: 5s/280°C

All specifications are restricted to QA test criteria. DRW: D. L. JIN, CHK: D.F. LEE, APP: H.Z. QIU, DC: 2011-07-14 UPD: 2016-05-03 / 2017-06-07 / 2025-05-13.

Rotary Switches

10 x 10 mm Sealed Rotary DIP Switches

RD82 Series

CODE

Real Code

04 Position	Real Code				
	C	1	2		
	0	●	●		
	1	●	●		
06 Position	Real Code				
	C	1	2	4	8
	0	●	●	●	●
	1	●	●	●	●
08 Position	Real Code				
	C	1	2	4	8
	0	●	●	●	●
	1	●	●	●	●
	2	●	●	●	●
	3	●	●	●	●
	4	●	●	●	●
	5	●	●	●	●
10 Position	Real Code				
	C	1	2	4	8
	0	●	●	●	●
	1	●	●	●	●
	2	●	●	●	●
	3	●	●	●	●
	4	●	●	●	●
	5	●	●	●	●
	6	●	●	●	●
	7	●	●	●	●
16 Position	Real Code				
	C	1	2	4	8
	0	●	●	●	●
	1	●	●	●	●
	2	●	●	●	●
	3	●	●	●	●
	4	●	●	●	●
	5	●	●	●	●
	6	●	●	●	●
	7	●	●	●	●
	8	●	●	●	●
	9	●	●	●	●
	10	●	●	●	●
	11	●	●	●	●
	12	●	●	●	●
	13	●	●	●	●
14	●	●	●	●	
15	●	●	●	●	

Complementary Code

04 Position	Complement Code				
	C	1	2		
	0	●	●		
	1	●	●		
06 Position	Complement Code				
	C	1	2	4	8
	0	●	●	●	●
	1	●	●	●	●
	2	●	●	●	●
08 Position	Complement Code				
	C	1	2	4	8
	0	●	●	●	●
	1	●	●	●	●
	2	●	●	●	●
	3	●	●	●	●
	4	●	●	●	●
	5	●	●	●	●
10 Position	Complement Code				
	C	1	2	4	8
	0	●	●	●	●
	1	●	●	●	●
	2	●	●	●	●
	3	●	●	●	●
	4	●	●	●	●
	5	●	●	●	●
	6	●	●	●	●
	7	●	●	●	●
16 Position	Complement Code				
	C	1	2	4	8
	0	●	●	●	●
	1	●	●	●	●
	2	●	●	●	●
	3	●	●	●	●
	4	●	●	●	●
	5	●	●	●	●
	6	●	●	●	●
	7	●	●	●	●
	8	●	●	●	●
	9	●	●	●	●
	10	●	●	●	●
	11	●	●	●	●
	12	●	●	●	●
	13	●	●	●	●
14	●	●	●	●	
15	●	●	●	●	

Gray Code

10 Position	Gray Code				
	C	1	2	8	
	0	●	●	●	
	1	●	●	●	
	2	●	●	●	
	3	●	●	●	
	4	●	●	●	
	5	●	●	●	
	6	●	●	●	
	7	●	●	●	
16 Position	Gray Code				
	C	1	2	4	8
	0	●	●	●	●
	1	●	●	●	●
	2	●	●	●	●
	3	●	●	●	●
	4	●	●	●	●
	5	●	●	●	●
	6	●	●	●	●
	7	●	●	●	●
	8	●	●	●	●
	9	●	●	●	●
	10	●	●	●	●
	11	●	●	●	●
	12	●	●	●	●
	13	●	●	●	●
14	●	●	●	●	
15	●	●	●	●	

Special Code

10 Position	Real Code				
	C	1	2	4	8
	0	●	●	●	●
	1	●	●	●	●
	2	●	●	●	●
	3	●	●	●	●
	4	●	●	●	●
	5	●	●	●	●
	6	●	●	●	●
	7	●	●	●	●
16 Position	Complement Code				
	C	1	2	4	8
	0	●	●	●	●
	1	●	●	●	●
	2	●	●	●	●
	3	●	●	●	●
	4	●	●	●	●
	5	●	●	●	●
	6	●	●	●	●
	7	●	●	●	●
	8	●	●	●	●
	9	●	●	●	●
	10	●	●	●	●
	11	●	●	●	●
	12	●	●	●	●
	13	●	●	●	●
14	●	●	●	●	
15	●	●	●	●	

ND

04 Position	Dezimal				
	C	1	2	3	4
	0	●	●	●	●
	1	●	●	●	●

NE

06 Position	Real Code				
	C	1	2	4	8
	0	●	●	●	●
	1	●	●	●	●
	2	●	●	●	●
	3	●	●	●	●

NF

16 Position	Complement Code				
	C	1	2	4	8
	0	●	●	●	●
	1	●	●	●	●
	2	●	●	●	●
	3	●	●	●	●
	4	●	●	●	●
	5	●	●	●	●
	6	●	●	●	●
	7	●	●	●	●
	8	●	●	●	●
	9	●	●	●	●
	10	●	●	●	●
	11	●	●	●	●
	12	●	●	●	●
	13	●	●	●	●
14	●	●	●	●	
15	●	●	●	●	

NG

04 Position	Real Code		
	C	1	2
	0	●	●
	1	●	●

NH

04 Position	Real Code		
	C	1	2
	0	●	●
	1	●	●