

Micro Switches

SPDT Miniature Micro Switches

MP57 Series



MP57HSA

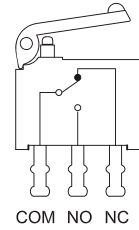
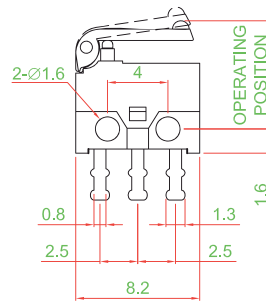
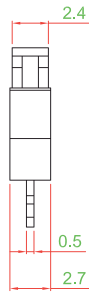

MP57HRA

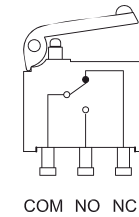
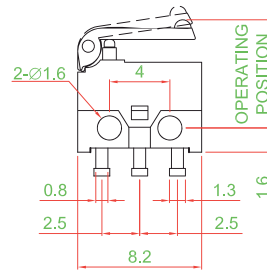
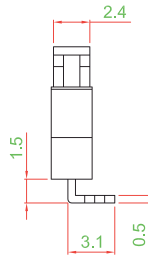

MP57HLA

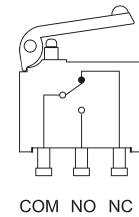
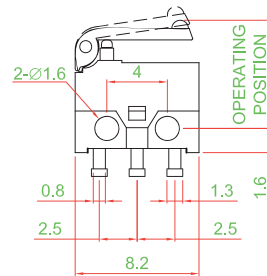
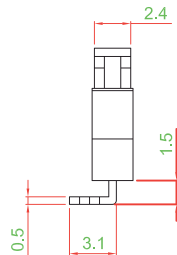

SPECIFICATIONS:

- > Rating: 0.7A30VDC*
- > Contact Resistance: 100 mohm Max. 1.5VDC
100mA by method of voltage drop
- > Insulation Resistance: 100 Mohm Min. 500VDC
- > Dielectric Strength: 500VAC 1 Minute (breakdown is not allowable)
- > Operating Force: 50gf Max.
- > Operating Life: 100,000 Cycles
- > Operating Temperature: -20°C ~ +70°C

MATERIALS:

- > Cover: POM
- > Actuator: PA
- > Base Frame: PA
- > Terminals: Silver Plating

P.C.B. LAYOUT:

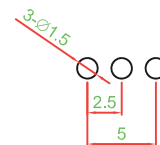

HOW TO ORDER:

UNIT: mm
Tolerance unless otherwise stated: ±0.2mm

MP57 ¹ ²

- | | |
|---------------------------|------------------------------|
| 1 TERMINALS: | 2 OPERATION POSITION: |
| HS PC Terminals Straight | A 6.2 ~ 7.2 mm |
| HR PC Terminals 90° right | |
| HL PC Terminals 90° left | |

