

Pushbutton Switches

IP67 Sealed Snap-Acting Pushbutton Switches

PB2 Series



PB2MDB40T7

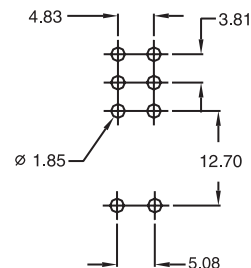
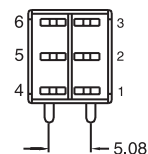
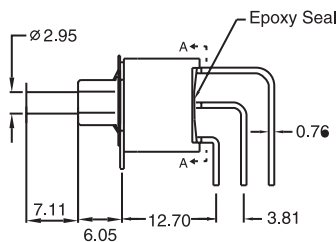
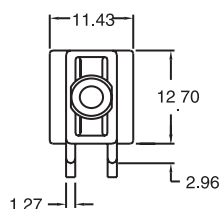

PB2MSB40VS2

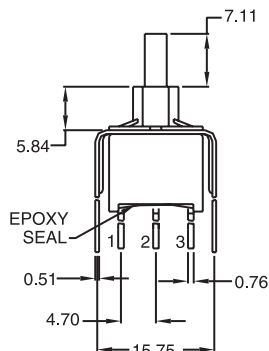
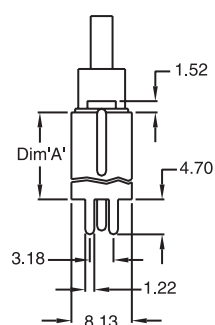

OPTION CODE	DIM. 'A'
VS2	11.68
VS3	16.00

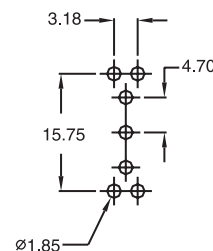

PB2MDB40VS2

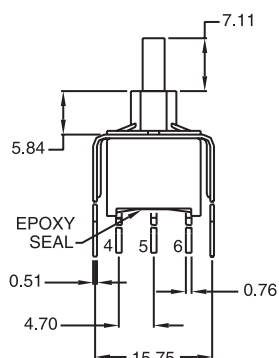
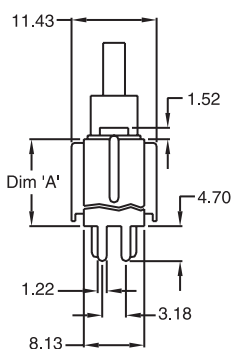

OPTION CODE	DIM. 'A'
VS2	11.68
VS3	16.00

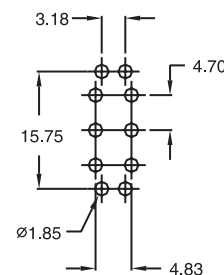

CAPS (Colors: white, black, green, red)

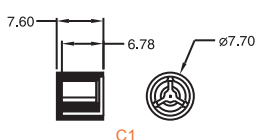

C1

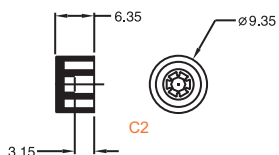

C2



C4

SWITCH FUNCTION

NO. POLES	MODEL NO.	SWITCH FUNCTION		CONNECTED TERMINALS		SCHEMATIC
		POS.1	POS.2	POS.1	POS.2	
SP	PB2MS	ON	MOM	1-3	1-2	
DP	PB2MD	ON	MOM	1-3,4-6	1-2,4-5	

MOM=MOMENTARY

BUSHING OPTIONS

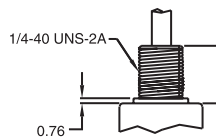

B10 Standard for T1

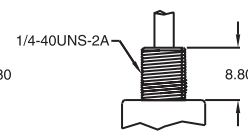

B20 Standard for T1

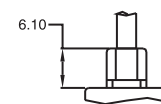

B40 Standard for T2, T6, T7, VS

TERMINAL OPTIONS

T1 Solder Lug

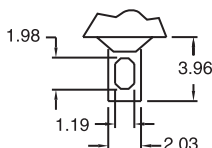

THK . 0.76

T2 PC Thru Hole

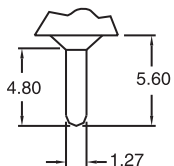

THK 0.76

SNAP-IN TERMINAL OPTIONS

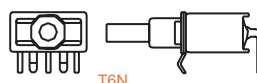

T6N



V2N

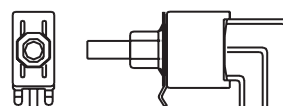

T7N