

Rocker Switches

21x15mm SP illuminated Rocker Switches

RK3 Series

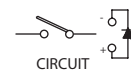

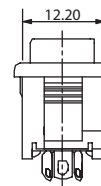
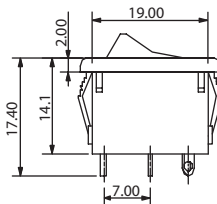
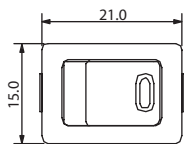



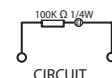
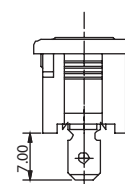
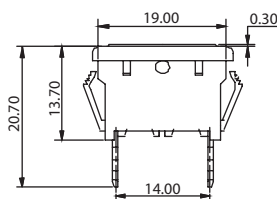
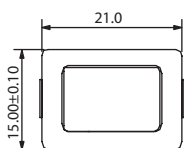
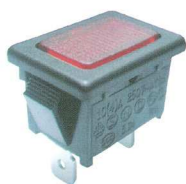



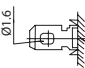

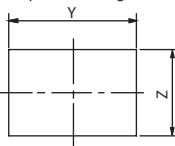
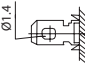

RK3S1 ON-OFF Switching

RK3S2 ON-ON Switching



RK3S3 Indicator Light

TERMINAL	ACTUATOR	ACTUATOR MARKING	PANEL SIZE												
 <p>P 4.8mm TAB, 0.8mm THICK, Ø1.6mm</p>	<p>4 Curve (No Illuminated)</p> 	<p>A  (No Marking)</p> <p>D </p>	<p>PANEL CUT-OUT Snap-in mounting</p> 												
 <p>Q 4.8mm TAB, 0.8mm THICK, Ø1.4mm</p>	<p>5 Curve (Illuminated)</p> 	<p>B  ON OFF</p> <p>E </p>													
 <p>L 2.9mm TAB, 0.8mm THICK</p>	<p>6 Flat</p> 	<p>C  O I</p> <p>F  O II</p>													
<table border="1"> <thead> <tr> <th>X (Panel thickness)</th> <th>Dimension Y</th> <th>Dimension Z</th> </tr> </thead> <tbody> <tr> <td>0.75 to 1.25 mm</td> <td>19.20 +0.1/-0 mm</td> <td>12.90 +0.15/-0 mm</td> </tr> <tr> <td>1.25 to 2 mm</td> <td>19.40 +0.1/-0 mm</td> <td>12.90 +0.15/-0 mm</td> </tr> <tr> <td>2 to 3 mm</td> <td>19.80 +0.1/-0 mm</td> <td>12.90 +0.15/-0 mm</td> </tr> </tbody> </table>			X (Panel thickness)	Dimension Y	Dimension Z	0.75 to 1.25 mm	19.20 +0.1/-0 mm	12.90 +0.15/-0 mm	1.25 to 2 mm	19.40 +0.1/-0 mm	12.90 +0.15/-0 mm	2 to 3 mm	19.80 +0.1/-0 mm	12.90 +0.15/-0 mm	
X (Panel thickness)	Dimension Y	Dimension Z													
0.75 to 1.25 mm	19.20 +0.1/-0 mm	12.90 +0.15/-0 mm													
1.25 to 2 mm	19.40 +0.1/-0 mm	12.90 +0.15/-0 mm													
2 to 3 mm	19.80 +0.1/-0 mm	12.90 +0.15/-0 mm													

How to order:

RK3

- 1** POLES:
- S** Single Pole
- 2** SWITCHING:
- 1** ON - OFF
- 2** ON - ON
- 3** Indicator Light
- 3** TERMINAL (See above drawings):
- P** 4.8mm TAB, 0.8mm Thick, Ø1.6mm (RK3S3 Only)
- Q** 4.8mm TAB, 0.8mm Thick, Ø1.4mm (RK3S1 & RK3S2 Only)
- L** 2.9mm TAB, 0.8mm THICK (RK3S1 & RK3S2 Only)
- 4** ACTUATOR (See above drawings):
- 4** Curve (No Illuminated) (RK3S1 & RK3S2 Only)
- 5** Curve (Illuminated) (RK3S1 & RK3S2 Only)
- 6** Flat (RK3S3 Only)
- 5** ACTUATOR MARKING:
- A** See above drawings
- B** See above drawings
- C** See above drawings
- D** See above drawings
- E** See above drawings
- F** See above drawings
- 6** ILLUMINATION:
- N** No Illuminated
- F** Green
- C** Red
- G** Blue (RK3S3 Only)
- D** Orange
- 7** BASE COLOR:
- A** Black
- H** Grey
- B** White
- 8** ACTUATOR COLOR:
- A** Black
- H** Grey
- B** White
- C** Red
- 9** WATERPROOF COVER:
- N** None Cover (Standard)
- W** With Waterproof Cover

General Specifications:

- FEATURES**
- Single pole Rocker switch up to 20A 125VAC
- MATERIALS**
- Contact Arm: Silver cadmium alloy
- Terminal: Silver plated copper
- Spring: Piano wire
- MECHANICAL**
- Temperature Range: -20°C to +125°C
- ELECTRICAL**
- Electrical Life: 10,000 cycles
- Rating: 20A125VAC, 12A250VAC
- 10A125VAC, 6A250VAC
- 6A125VAC, 3A250VAC
- 6A250VAC
- 10(4)A250VAC~T125
- Initial Contact Resistance: 20m Ω max.
- Insulation Resistance: 100M Ω min. at 500VDC